

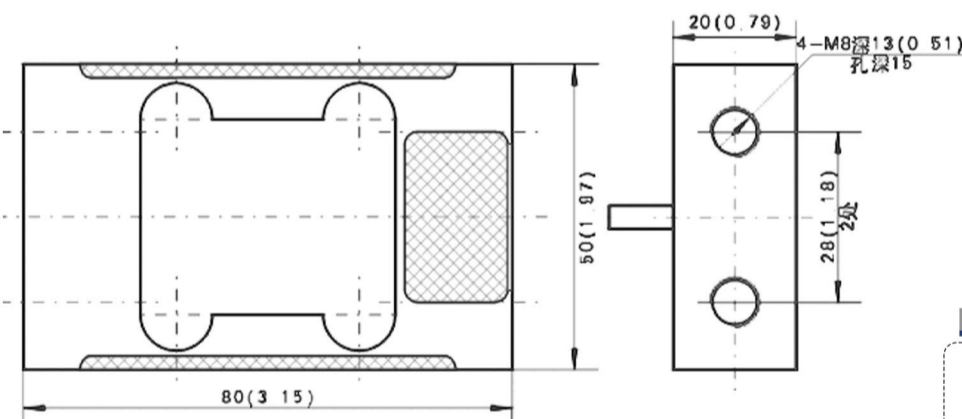

DESCRIPTIONS 描述

- MA1050 铝制单点称重传感器可以满足 4kg-20kg 量程范围内的精确称量
 - 硅橡胶密封，表面阳极化，防腐性能佳
 - 结构简单，安装方便
 - 适用于包装机械等各类电子称重设备
 - 推荐秤台尺寸：200*200mm
- MA1050 aluminum-alloy single point load cell can meet the accurate weighing in the capacity of 4kg~20kg
 - Silicone rubber seal, colourless anodized, and good corrosion resistance
 - Simple structure, easy to install
 - Suitable for single or double load cell structured platform scales
 - Recommended platform size: 200 x 200 mm

DIMENSIONS 尺寸



接线方式 Schematic

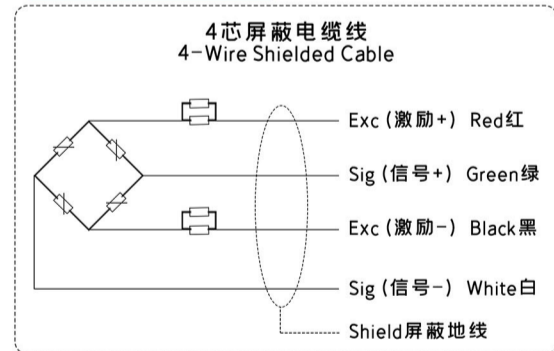

SPECIFICATIONS 参数

| | | |
|-------------|-------------|-------------------|
| 额定载荷 | kg | 4/8/10/15/20 |
| 输出灵敏度 | (mV/V) | 2.0±0.2 |
| 综合误差 | (%FS) | ≤ ±0.02 |
| 蠕变 | (%FS/30min) | ≤ ±0.0167 |
| 温度对输出灵敏度的影响 | (%FS/10℃) | ≤ ±0.0175 |
| 温度对零点输出的影响 | (%FS/10℃) | ≤ ±0.02 |
| 零点输出 | (%FS) | ≤ 2 |
| 温度补偿范围 | (℃) | -10 ~ 40 |
| 允许使用温度范围 | (℃) | -35 ~ 65 |
| 输入阻抗 | (Ω) | 406±6 |
| 输出阻抗 | (Ω) | 350±3 |
| 绝缘阻抗 | (MΩ) | ≥ 5000(50VDC) |
| 推荐激励电压 | (V) | 5 ~ 12(DC) |
| 最大激励电压 | (V) | 18(DC) |
| 安全过载范围 | (%FS) | 120 |
| 防护等级 | | IP65 |
| 电缆线规格 | mm | φ3.8 |
| 电缆线长度 | m | 0.5 |
| 推荐秤台尺寸 | mm | 200 x 200 |
| 四角误差 | | 0.02% 加载值 / 100mm |
| 推荐安装扭矩 | N.m | M8: 25 |